

R1 C1

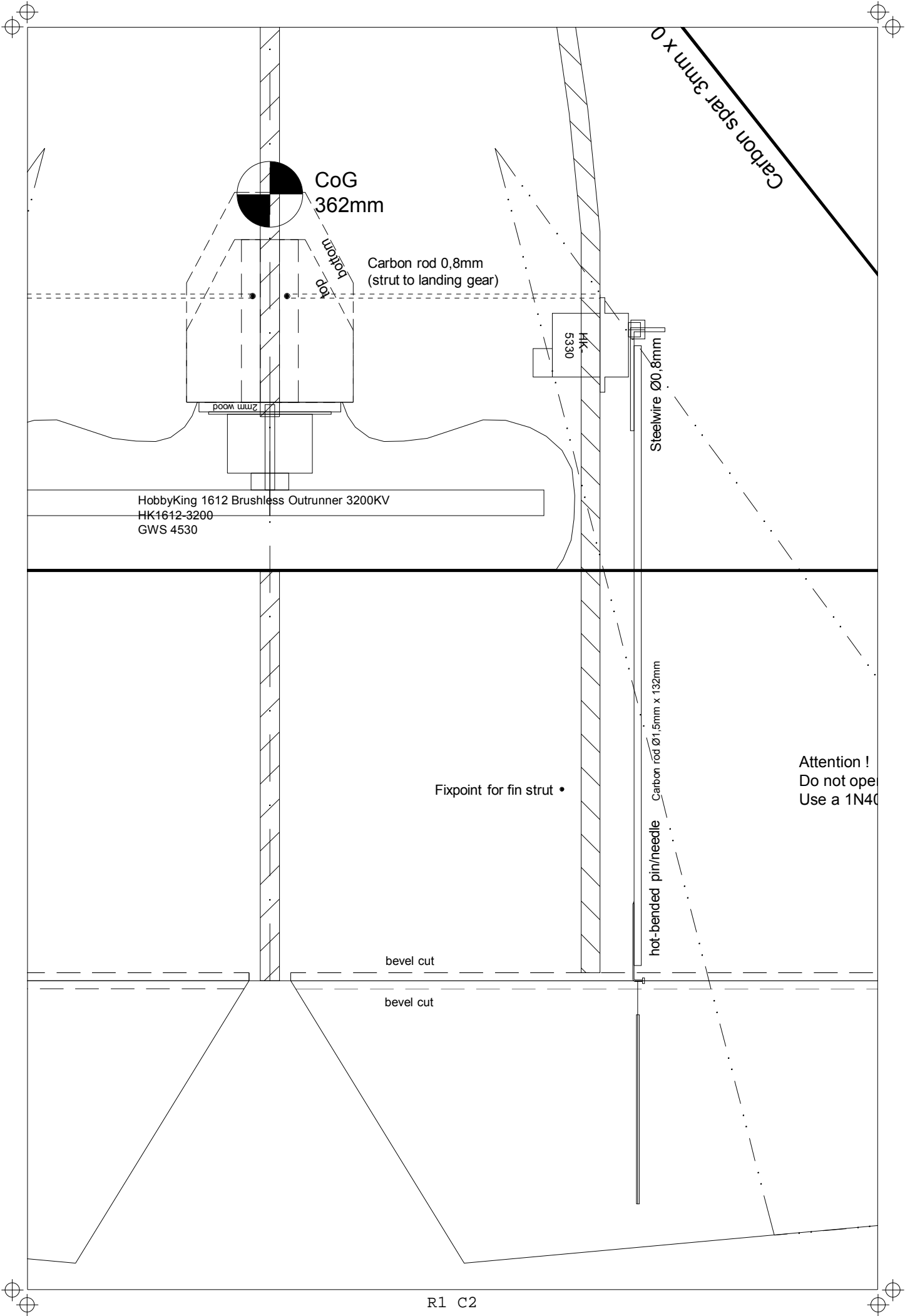

HobbyKing 1612 Brushless Outrunner 3200KV  
HK1612-3200  
GWS 4530

Carbon rod 0,8mm  
(strut to landing gear)

Carbon spar 3mm x 0

Steelwire Ø0,8mm

Carbon rod Ø1,5mm x 132mm  
hot-bended pin/needle

bevel cut

bevel cut

Fixpoint for fin strut •

Attention !  
Do not open  
Use a 1N40

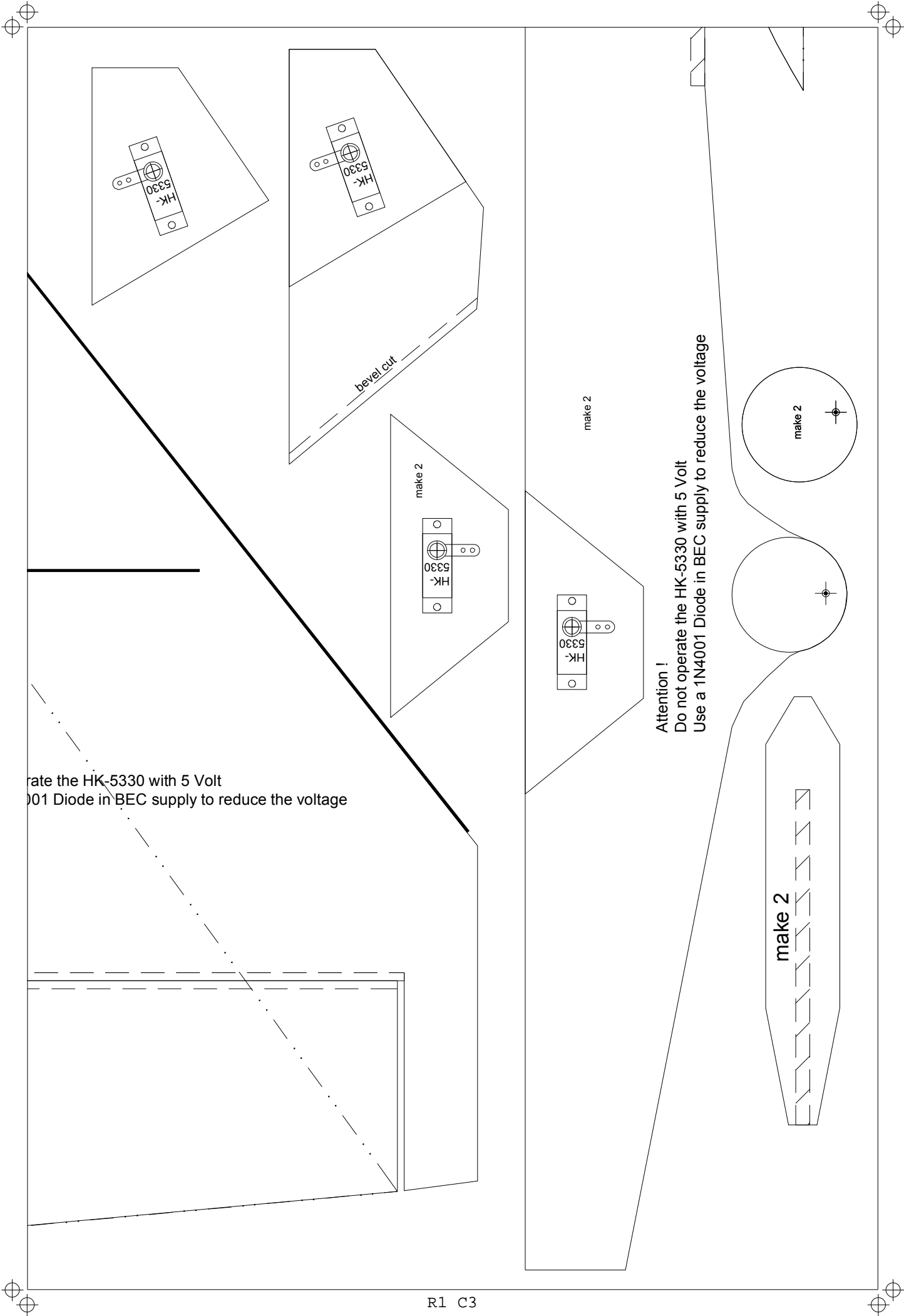

Do not operate the HK-5330 with 5 Volt  
1N4001 Diode in BEC supply to reduce the voltage

bevel cut

make 2

make 2

Attention !  
Do not operate the HK-5330 with 5 Volt  
Use a 1N4001 Diode in BEC supply to reduce the voltage

make 2

make 2

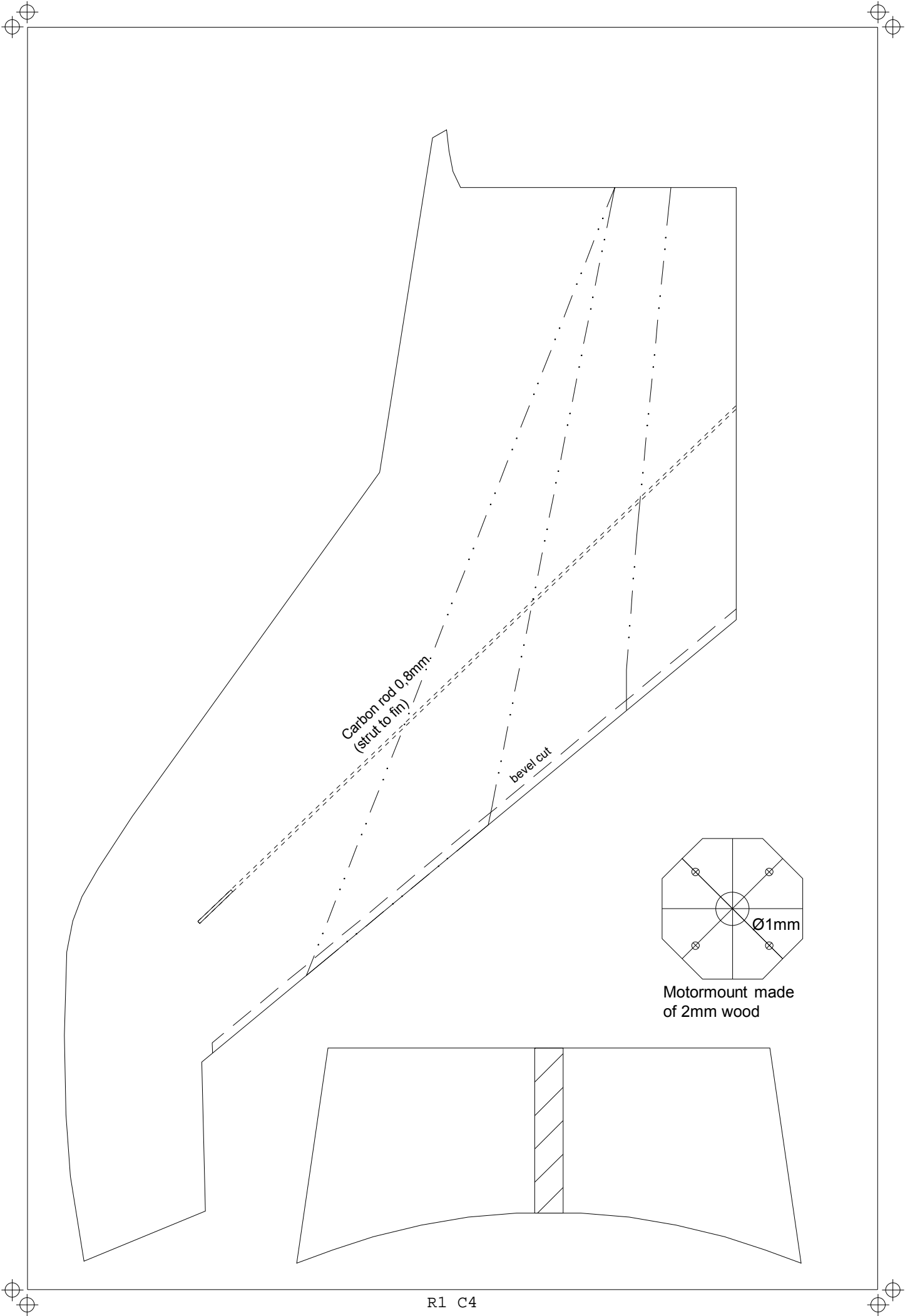

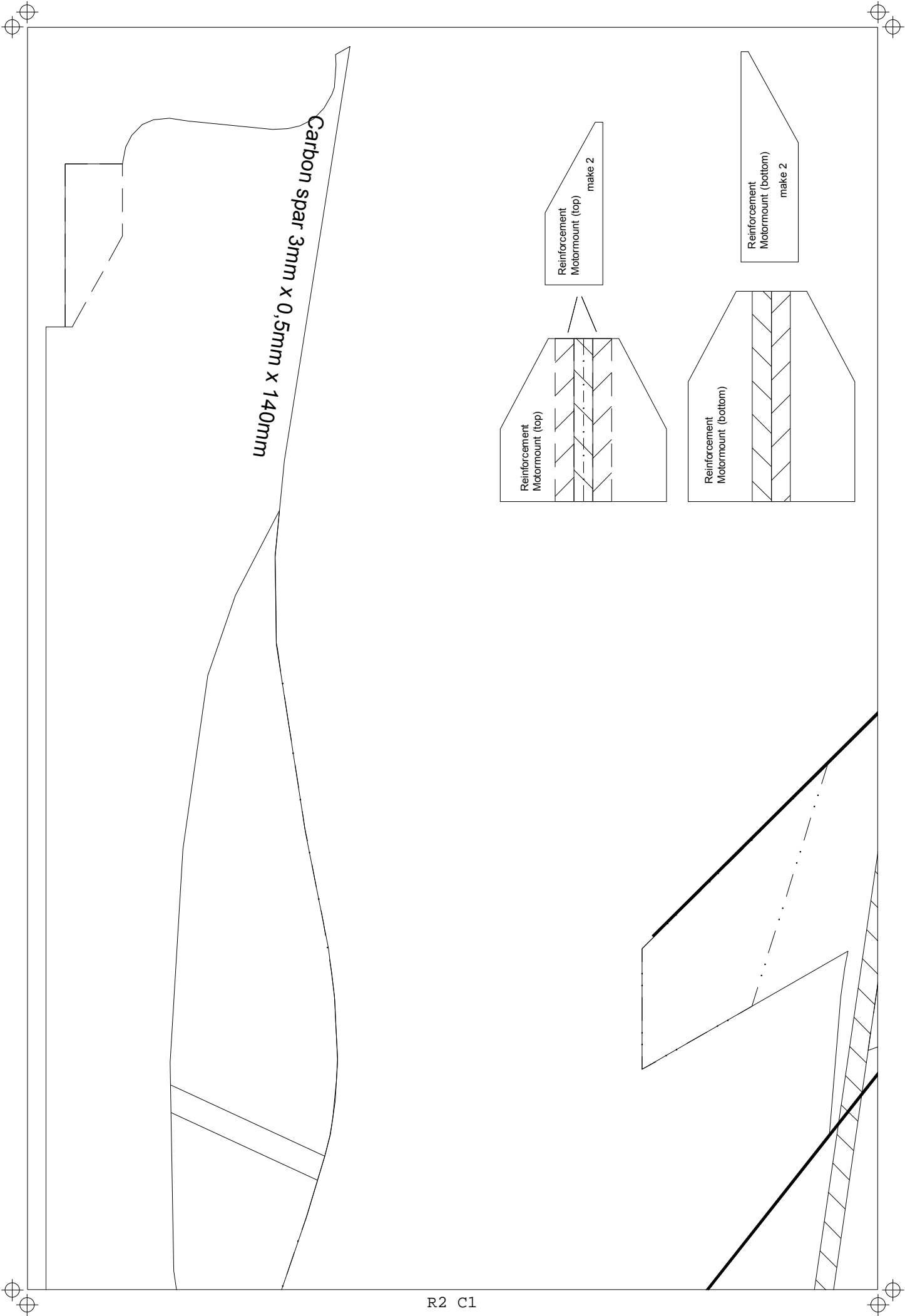

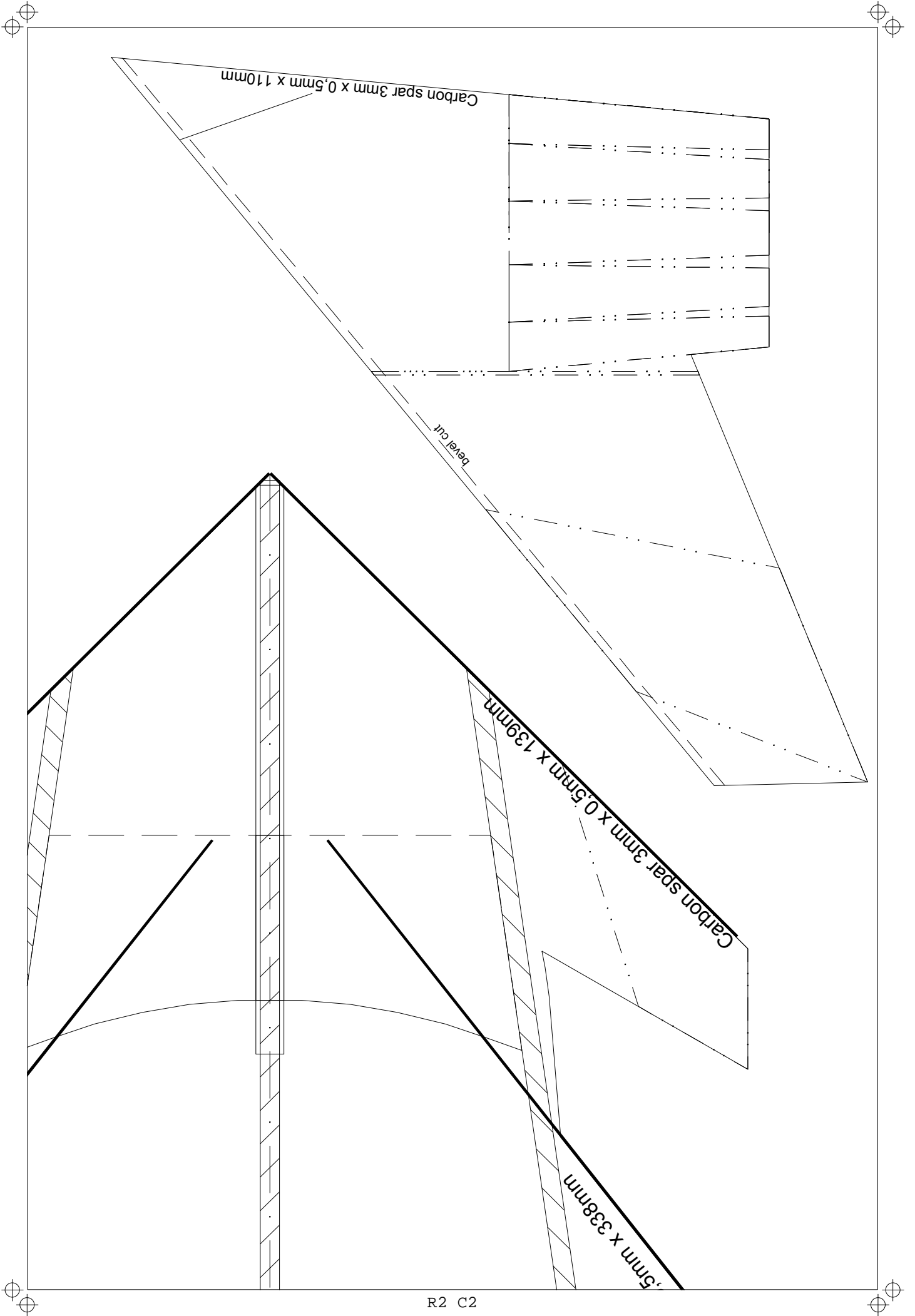

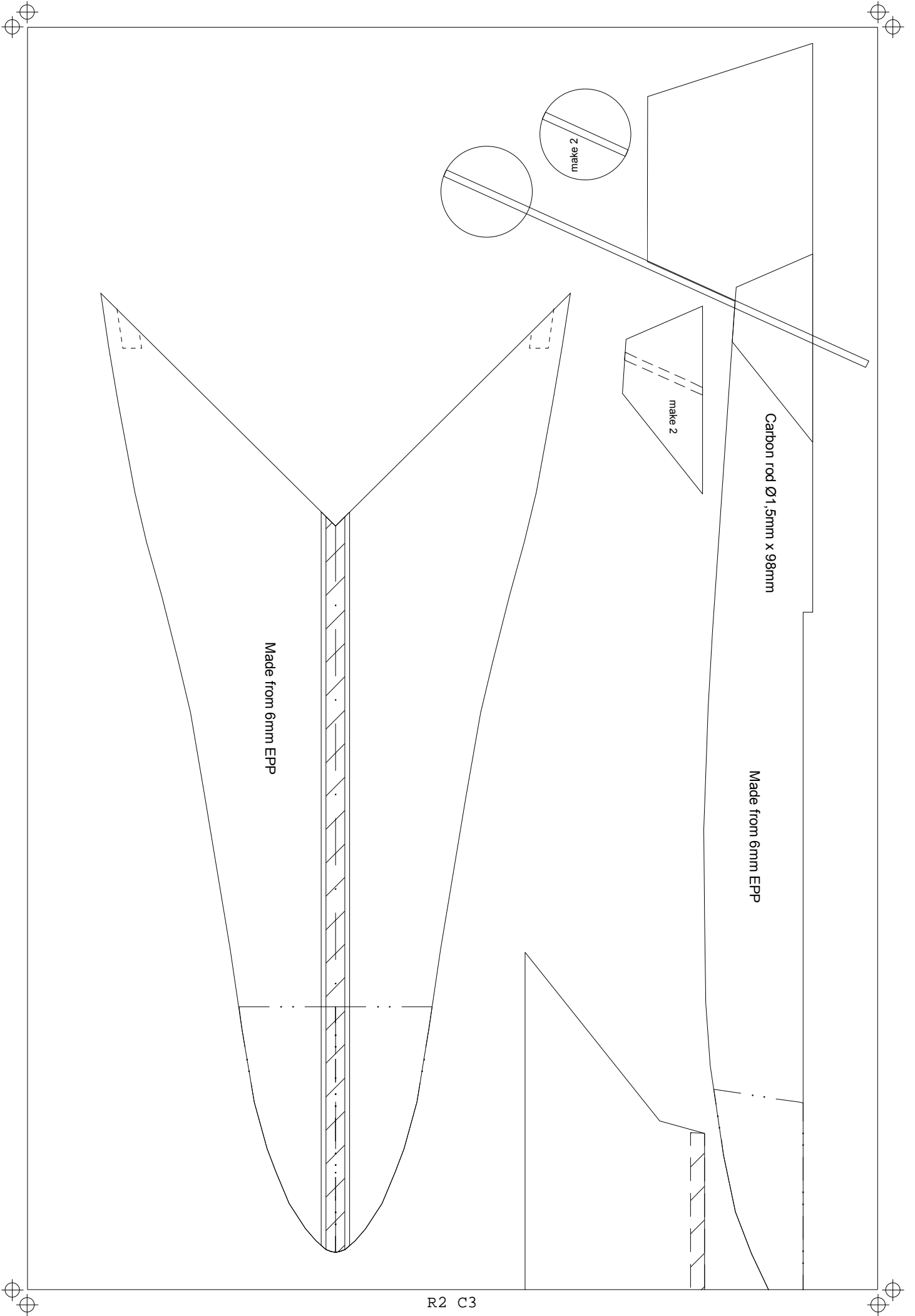

# 75% Version !

Original design and plans by Stig Henrikson

see [www.rcgroups.com](http://www.rcgroups.com), search for "Indoor Jet" in "titles only"

or go directly to

<https://www.rcgroups.com/forums/showthread.php?2792404-Indoor-Jet>

Redesign (minor shape changes, thicker carbon) by Robert

<http://www.roberts-r2d2-bau.de/fmbindex.html>

If not otherwise marked, all Parts made of 4mm EPP 20g/dm<sup>3</sup>

HobbyKing 1612 Brushless Outrunner 3200KV (HK1612-3200)

GWS 4530

HK-5330 Ultra-Micro Digital Servo 0.17kg / 0.04sec / 1.9g (9225000002)

TURNIGY Plush 6A / .8bec/6g Speed Controller

Diode 1N4001 (to reduce BEC Voltage to 4,3 Volt)

Turnigy nano-tech 180mah 2S 25~50C Lipo Pack

